



**MANUAL**

**MODEL : GFP – 2000**



**[www.leafplasma.com](http://www.leafplasma.com)**

---

## INSTRUCTION MANUAL

Please read this manual carefully before using the product for a safe use. In addition, please keep this manual for a future use, and when transferring this product to another person, be sure to hand it in with this manual.

---

# C O N T E N T S

## PRODUCT COMPOSITION | 03

## INTRODUCTION | 04

1. 6 skin care functions are in one | 04
2. Special features of LEAF | 04
3. FUSION PLASMA™ | 05

## Product Name | 07

## How to use | 08

1. Exfoliation and promoting absorption | 08
2. Micro current lifting | 09
3. Battery Charging | 10
4. How to use buttons | 11

## PRODUCT SPECIFICATIONS | 14

## PRODUCT WARRANTY | 14

## FAQ | 15

## ATTENTION | 16

1. Attention for a device | 16
  2. Attention for a battery | 17
  3. Attention for battery charging | 17
  4. Check before a use | 18
-

## PRODUCT COMPOSITION



1 Main Body



2 USB cable



3 Charging cradle



4 Manual



5 Brief manual

## INTRODUCTION

### 1 6 skin care functions are in one

#### Fusion Plasma



- Securing stratum corneum passage
- Wrinkle Improvement
- Rough skin texture improvement

#### Smart Boosting



- Accelerate Cosmetic Application
- World's first, 3<sup>rd</sup> generation Electroporation technology

#### Probe Warming



- Reserve collagen
- Promote blood flow and metabolism

#### Vibration



- Skin muscle relaxation
- Blood flow promotion

#### Photo facial



- LED simultaneous operation
- Promoting blood flow and anti-aging

#### Micro Current



- lifting
- Promoting cell regeneration

### 2 Special Functions of LEAF

#### Smart Update Function

Select the best course by the type of cosmetics by mobile phone screen communication.

By updating the information of the cosmetics that fit to my skin on the device, you can customize it and increase the absorption rate dramatically.

#### Convenient voice guidance function

Provides voice guidance for an easy care without the first aid, You can choose either a voice guide or a sound effect.

#### Dual-Charging

#### Cradle docking Charging / Main Body Sole Charging

Comfortable to use at home, at shop Charging without cradle while on travel using USB charger.

## PRODUCT INTRODUCTION

### 3 FUSION PLASMA™

- It is an unique patented skin care solution consisting of three steps.

#### 1 Formation of the stratum corneum through Fusion plasma

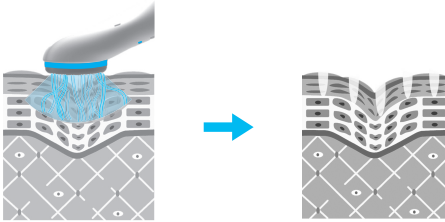

Fusion plasma energy creates a microscopic pathway in the stratum corneum. Since the passageways are formed at a microscopic depth, a primary passage is secured to absorb the active ingredients of the cosmetic without damaging the skin. It stimulates the skin with the external stimulation by heat of the fusion plasma, induces skin regeneration and promotes skin lifting.

#### 2 Securing passage by 3rd generation electroporation and inputting active ingredient

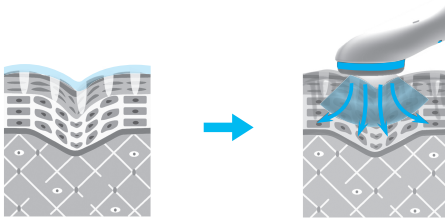

Using 3rd generation electroporation, it maintains the passage formed in the first step and secures additional passage to promote absorption of active ingredient in cosmetics. The third-generation electroporation primarily increases the permeability of the field strength and cell membrane, and secondarily moves the active ingredients of the cosmetic product down the stratum corneum to promote absorption.

## PRODUCT INTRODUCTION

### 3 Lifting using microcurrent

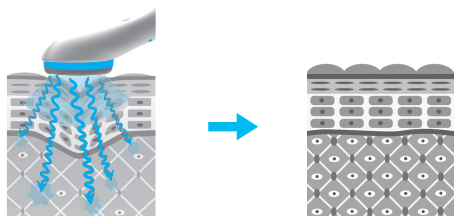

It is a step that stimulates lifting by helping to regenerate ingredients related to skin elasticity by applying lower electric stimulus than the previous methods. Collagen and elastin-related ingredients, such as elasticity, age begins to slow down the recovery. At this time, the energy of the microcurrent delivered to the skin through electrical stimulation stimulates the ingredients to help regenerate and promote skin lifting.

# PRODUCT NAME

## Main Body



## Charging Cradle

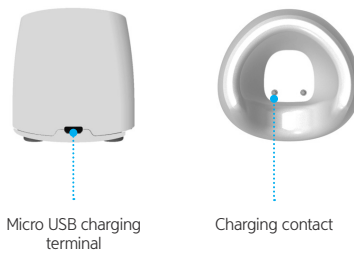

## HOW TO USE

### 1 Exfoliation and promoting absorption

#### ① Fusion Plasma Step

- Fusion plasma step to secure stratum corneum passage.

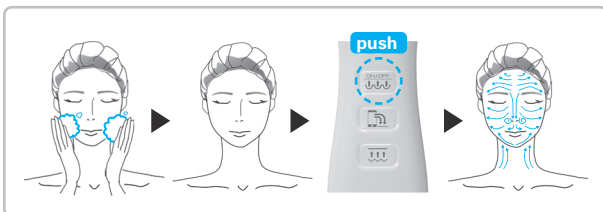

- ① Wash your face with cleansing cream or foam.
- ② Wait nothing applied wait until the water dries slightly.
- ③ After turning on the power [⏻], it begins from 1st intensity. To select Fusion Plasma mode in other modes, press shortly to change the Fusion Plasma mode.
- ④ Handle the probe to slightly touches the surface of the skin, lightly massage the entire face as if brushing.

\* If there is water on your face, plasma does not work properly. Please dry thoroughly before proceeding with Fusion plasma step.

#### ② Smart Boosting Step

- Promoting cosmetic application by skin boosting by Electroporation





## HOW TO USE

- ① Apply proper amount of cosmetics evenly over the face.
- ② Press smart boosting mode button. It begins from 1st intensity.
- ③ Put the probe in close contact with the face and evenly boost whole face as if massaging for about 5 mins. The upper part of the head makes it easier to care for narrow areas.
- ④ You can adjust the use time according to the degree of absorption of cosmetics.
- ⑤ Depending on the amount of oil and moisture in your skin, it may stop working. Apply sufficient amount of cosmetics and make the optimal condition for absorbing cosmetics.
- ⑥ When using on the neck, please be careful not to directly affect the uvula.

## 2 Micro current lifting

- Lifting by micro current



- ① Wash your face with cleansing cream or foam.
- ② Apply proper amount of cosmetics for lifting and anti-aging evenly over the face.
- ③ Press shortly the lifting mode button. It begins from 1st intensity.
- ④ Apply the head of the device to the surface of the face for 5 minutes and slowly massage it while on lifting mode along the direction of the arrow as in the picture.
- ⑤ You can adjust the use time according to the degree of absorption of cosmetics.

## HOW TO USE

### 3 Battery Charging

#### Charging by cradle

- It is comfortable to charge at home.

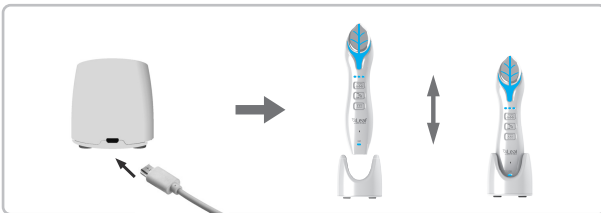

- 1 Connect the charge cable to the micro USB charge port on the power adapter and charge cradle.
- 2 Charge the main unit on the cradle.
- 3 Moisture could cause corrosion. So please keep the charging cradle and main body charging contacts free from moisture or water.

#### Charging the main body alone

- Charging is available without cradle.



- 1 Connect the micro USB cable to the Micro USB charging jack on the bottom of the unit.
- 2 The micro USB charging terminal of this unit is a charging terminal that does not support communication with a computer or a smart device.

## HOW TO USE

### Battery Status

- When the battery is low, the head turns red. And after a voice guide or sound effect, the power will automatically turn off by itself.
- The battery status indicator lights red when charging and green when fully charged.
- It can be used up to 10 days when used for 10 minutes once a day. It takes about 2 ~ 3 hours to be fully charged.

#### 4 How to use button

##### Power on | off



- Press the power button on the main unit to turn on the power.
- When the main unit is on, press the power button for more than 3 seconds to turn off the power.
- If the main unit is turned on and operation is not performed, the power automatically turns off after 5 minutes.

##### Changing the voice guidance function



- Press the Micro current mode button more than 3 seconds for each mode sound option is processed in order, Voice guidance ▶ Beep sounds ▶ Silent mode.
- Basic setting is Voice guidance.

## HOW TO USE

### Changing the Mode

- When using the skin care mode, press the other button shortly to switch. All skin care modes start with 1st intensity.

Ex) If press the lifting mode button during Fusion plasma mode → Changes to lifting mode

- If you want to return to skin care mode while using smart update mode, press the button shortly to change it.

### Intensity Change



- Press the button of the using mode to change the intensity.

Ex) If press smart Boosting Mode while on the same Mode → It changes intensity level

- The intensity of each mode appears in the level indicator.

### Smart update mode

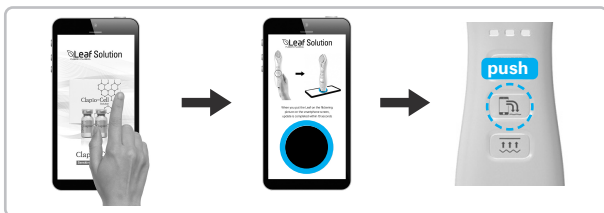

- After accessing the mobile website, select the desired cosmetics.

## HOW TO USE

- When the page that can be communicated is displayed, press and hold the smart boosting mode button of the main body for 3 seconds or longer, and change into the smart update standby status.

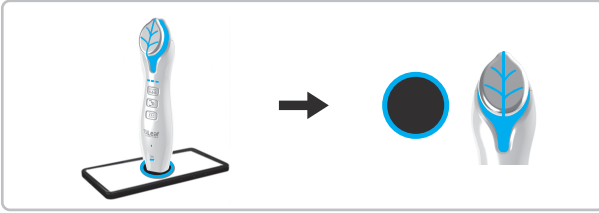

- When you put the main body in the center of the circle that blinks, It updates information about cosmetics and then will be completed within 10 seconds.

## PRODUCT SPECIFICATIONS

- Product name : LEAF FUSION PLASMA
- Model name : GFP-2000
- Level control : 3 levels
- Control button : Fusion Plasma, Smart Boosting, Micro Current
- Power : Built-in lithium polymer 3.7V 500mAh
- Power Consumption : 1W max
- Usage time : If fully charged, up to 7 days when using 15 minutes per day
- Charging type : standard micro USB  
(Connect with computer USB port or mobile phone charger)
- Product composition : Main body, Cradle, Micro USB charging cable
- Size : 42(W) X 190(H) X 40(D)(mm)
- Weight(main body) : 120g

## PRODUCT WARRANTY

- This product is guaranteed for one year from the date of purchase.
- If it is difficult to confirm the warranty period, the warranty period will be applied 15 months after the date of manufacture.
- The defective from product's production will be repaired or replaced free of charge depending on the condition.
- Damage caused by user's negligence will not be covered under the warranty period.
- Repairs other than designated service centers are excluded from the warranty.
- The service period will not be extended after repair for free or for charge.
- This warranty will not be reissued.

|                   |                    |                  |          |
|-------------------|--------------------|------------------|----------|
| Product Name      | LEAF FUSION PLASMA | Model            | GFP-2000 |
| Serial no.(S/N)   |                    |                  |          |
| Place of Purchase |                    | Date of Purchase |          |
| Client's info     | Name               | Tel.             |          |
|                   | Address            |                  |          |

\* GCS Co.,Ltd. The products can be exchanged or compensated according to the Fair Trade Commission Notice of Consumer Dispute Resolution Standards.



HQ and Factory : #1008 Sunil Technopia Bldg.,  
555 Dunchon-daero, Jungwon-gu, Seongnam-si,  
Gyeonggi-do, Korea

Tel : + 82 - 2 - 555 - 1536 Fax : + 82 - 2 - 3142 - 7670  
Customer Service Center : +82 - 70 - 7700 - 7373

## FAQ

- Q** The device is not working at all.
- A** If the battery is low, the unit may not operate. Please charge the device and use it again.
- Q** The battery status indicator does not light up nor charge.
- A** Make sure that the charging adapter is plugged into the outlet. If there are foreign substances on the charging contacts, charging may not work properly. Wipe the charging contacts of the main body and cradle well with a cotton swab and try charging again.
- Q** While charging, pressing the power button does not work.
- A** This unit can not be used while charging. Disconnect the charging adapter terminal from the device before use.
- Q** I can not feel the vibration even when I turn on the power.
- A** The LED flashes and vibrates only when the skin is in contact. If the skin is too dry, it may not work properly because it is unfavorable skin condition to use the device. Please apply the device after applying enough cosmetics on your skin.
- Q** In smart boosting mode, communication from the phone is not working.
- A** Please refer to page 12~13 of this manual and proceed again according to the procedure. If you start to access the mobile website after the smart phone enters the smart update mode, Smart Update mode will end while accessing the mobile web site and it will be in standby mode. Therefore, please access Smart Update mode after accessing mobile website. In order to make communication more convenient, you should connect Smart Update mode after you put the main body in the center of the circle.
- Q** There is a problem other than the above.
- A** Please contact Customer Service Center.

## ATTENTION

### ■ Attention for device

- Do not disassemble, repair or modify this product by yourself. Failure to do so may result in fire, electric shock, or injury.
- Do not pierce the product gap with sharp metallic objects such as keys or hairpins.
- Do not drop or shake the device.
- Please be careful not to fall when transporting the product.
- When removing the cable, hold it by the end of the cable. You may get injury or damage the device.
- Do not allow children to use the product.
- When not using for a long time, please be sure to turn off the power.
- When handling the product, use a soft, dry cloth, cosmetic cotton, cotton swab, and etc. If the surface is too dirty, use a soft cloth dampened with water. Do not clean the surface of the product too hard or with strong chemicals such as benzene or thinner. It may deteriorate the surface of the product.
- After using the head of the main unit, wipe the rest of the cosmetics with a soft acetone on a soft, dry cloth, cosmetic cotton, or cotton swab.
- For smooth operation of the product, please install it in a place free from electromagnetic interference.
- Do not use products that use high-voltage electricity near this product. This product may be damaged by electric shock.
- Use in dry environment may cause static electricity. Using the product after touching metal objects can prevent static electricity.
- Be careful not to expose to direct sunlight, or hot place such as inside the car.
- Do not store or install in the following places. It may cause fire, electric shock and breakdown.
  - Place where direct sunlight enters or where electric heater is generated
  - Where the temperature is too high (over 40 °C) or low (below 0 °C)
  - Where too much moisture, dust, soot, etc.
  - Near flammable substances or volatile liquids
  - Near water or other liquids such as drains or sinks
  - Dishwasher, oven, washing machine, etc.
  - Where there is a strong vibration or magnets are



## ATTENTION

### ■ Attention for battery

- Do not disassemble or change the built-in battery.
- If you are not going to use it for a long time, charge the battery at least once every three months to keep the battery life.
- Please charge the battery from time to time before the battery is completely discharged. Frequent full discharges can shorten battery life.
- Do not shock the product, put it in water, or store it in the car for a long time.
- Dispose used batteries according to the manufacturer's instructions.

### ■ Attention for charging

- Use only the indicated power and voltage.
- When not using the product, be sure to turn off the power and charge it.
- Make sure that the charging adapter and USB charging terminal connections are securely plugged in.
- When moving the product, unplug the power cord and all cables connected to the product.
- Do not immerse or clean the charging cradle, charging cable, or main unit. It may cause fire or electric shock. Wipe it with a dry cloth or tissue.
- Do not place the charge cable near heated surfaces.
- Do not damage, process, bend, twist, or heat the charging adapter and USB charging cable. Damage to the cord may cause fire or electric shock.
- Do not put it on the bedding, electric plates or carpet and do not charge for a long time. It may cause malfunction or fire due to internal temperature rise.
- Connecting the power cord of multiple products to one outlet at the same time may cause a fire due to overheating.
- If thunder or lightning strike, it may cause fire. Please unplug the power plug.

## ATTENTION

### ■ Please check before use

- Please consult your dermatologist if you have any of the following conditions:
  - In case of skin disease, allergic or sensitive skin, etc.
  - If skin irritation such as redness or tingling of the skin continues after use
  - If you are on skin recovery period due to skin procedures
  - Instant use after treatments or operations
  - Pregnancy, menstruation, women who are breastfeeding or whose immunity is weak
  
- Do not use this unit for patients with the following symptoms.
  - Metallic allergy sufferers
  - Pain, tardiness
  - Severe heart disease
  - High fever
  - Severe blood pressure abnormality
  - Steroid hormone taker
  - Children under 12 years old
  - Pregnant woman
  - Capillary vasodilator
  - Patients with infectious diseases
  - Patients with other skin diseases
  
- Do not use this unit in the areas listed below.
  - Bleeding area
  - Severe acne
  - Ear, Adam's apple
  - Mucous membrane including oral cavity
  - Areas with metal prosthetic devices
  - Traumatic area
  - Fractured area
  - Areas with skin irritation
  - Electronic Device implantation area
  
- Do not use this unit while driving or walking.
- Do not use this unit immediately after shaving.
- Do not stop the head at one place, but move from side to side according to the operation manual.

## ATTENTION

- Please observe the recommended usage time.
- Before use, remove the metallic accessories where the head touches.
- Do not use the unit for any purpose other than those described in this manual.
- It is not recommended to use for body as it is for facial purpose.
- If you have sensitive skin, we recommend that you use it when there is no symptoms after testing the product on the inside of the arm area.



**[m.leafplasma.com](https://m.leafplasma.com)**

Access the QR Code by Cell Phone  
and enjoy Leaf Smart Boosting Mode!

